

Application Ref.	PA/2025/0889 – C-1965097
Location	70 Wyre Drive, Worsley, M28 1HN
Proposal	Subdivision of plot and creation of new dwelling
Consultee	Salford Highways Officer (DM)
Date	10/12/2025

This applicant is for subdivision of plot and creation of new dwelling.

With reference to the existing site plan, it indicates that there is a circa 9.5m wide dropped kerb of which is incorrect, please see google image below. The existing dropped kerb is only approximately 5m wide with concrete transition kerbs on either side.



With reference to the proposed site plan, it also indicates that there is a circa 9.5m wide dropped kerb of which is incorrect. With reference to the proposed site plan image below the applicant must amend both their existing and proposed site plan with the correct dropped kerb length of 5m with concrete transition kerbs on either side. Also indicate the existing dropped kerb will be extended to the south by circa 6.5m and terminate with a transition kerb. It is also noted that the proposal will impact on the existing drainage gully within the highway and therefore it will need to be relocated by circa 4m to the south of the extended dropped kerb.

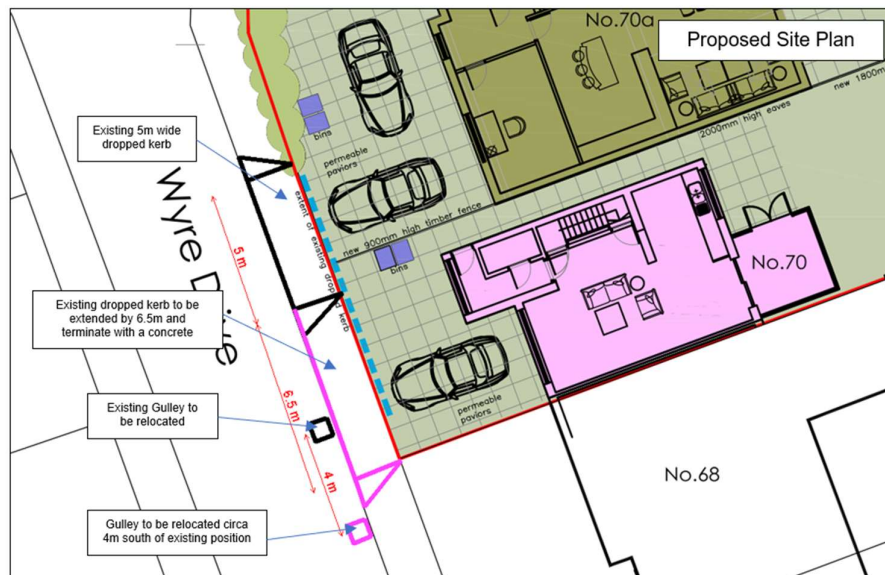

Recommendations:

The Local Highways Authority currently cannot support the proposal until the issues raised above has been fully addressed and shown on both the existing and proposed site plans.

Kind regards,

Steve Ho
Highways Development Control
Email steve.ho@salford.gov.uk