

Phase 1 - Proposed External Level Access Works Plan
1 : 50

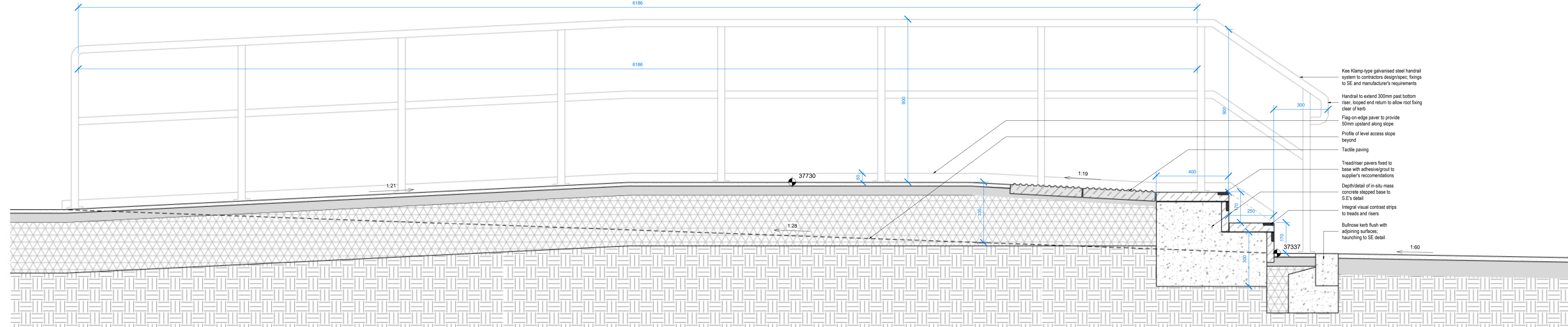

2. Phase 1 - Stepped access section
1 : 10

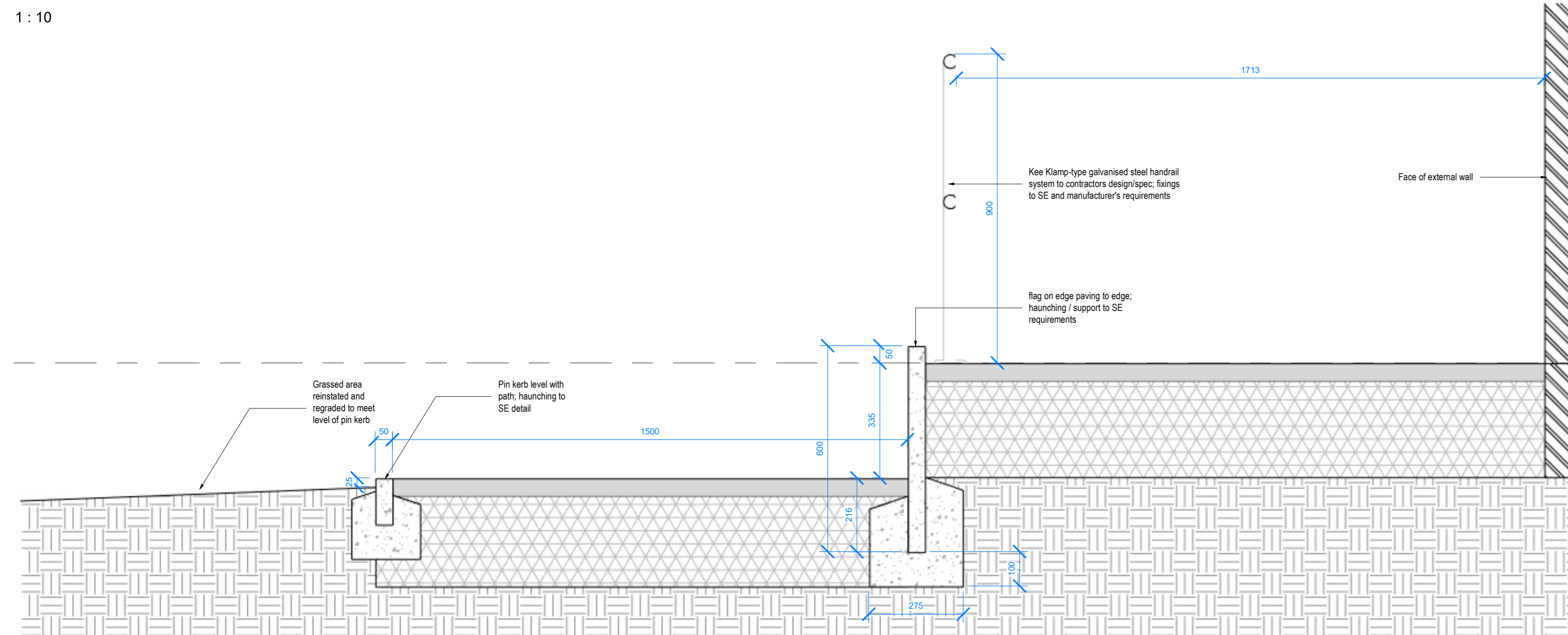

3. Phase 1 - Sloped access cross-section
1 : 10

LEGEND:

- HL-01 Asphalt road surfacing; refer to Civil Engineer's typical details for sub-base / bit-lime
- HL-02 Concrete paving
Materials: Tactile Hazard Warning Pavers - Natural 400mm x 400mm
- HL-03 Step paving units
Materials: Conservation S Step Treated - Charcoal, WITH BLACK VISIBLY STRIP, 400mm x 170mm x 40mm
- HL-04 Concrete pin kerb to path/glass boundary
- HL-05 Flag-on-edge paver
Materials: Conservation X Textured - Charcoal, size varies to suit
- HL-06 H&S Kerb - refer to Civil Engineer's typical details
- HL-07 Dropped Kerb - refer to Civil Engineer's typical details
- HL-08 Substone Kerb - refer to Civil Engineer's typical details (top flat flush with adjacent surfaces to provide level access)
- HL-09 Linear drainage channel system - ACO MULTIDRAIN BRISLAD 100
- LM-01 New thermoplastic line markings to accessible paving spaces (2m)

GENERAL NOTES:

- All dimensions to be checked on site. The Contractor shall verify and be responsible for all dimensions.
- DO NOT scale the drawing - The drawing must not be scaled for any purpose, refer to written dimensions only.
- Any queries or doubts, drawing errors, omissions or discrepancies shall be reported to Seven Architecture without delay and prior to works being carried out.
- This drawing is subject to statutory approvals.
- All works are to be in accordance with the planning approval and my subsequent approval. Local Authorities planning correspondence including drawings, documents and reports.
- All works are to comply with the Building Regulations, British Standards, Code of Practice and any Local Statutory requirements.
- All works are to comply with current Health & Safety Legislation, HSE recommendations, guidance and the current CDM regulations.
- All architectural drawings are to be read in conjunction with the relevant architectural specifications and outline specification sheets.
- All the details and setting-out drawings to be read in conjunction with the relevant consultants and subcontractor drawings.
- All details and setting-out drawings are design intent only. Final arrangement is subject to design development and coordination with Design Team consultants and relevant subcontractors.

REV.	DESCRIPTION	DATE	DRAWN	CHECK
P01	Issue for Information	06/11/25	JAV	DS
P02	Issue for Information	10/11/25	JAV	DS
P03	Issue for Information	11/01/25	JAV	DS

DRAWING SCALE:
1:100 @ A0

KEY PLAN (NTS):

CLIENT:
Consilium Academies

PROJECT TITLE: Ellesmere Expansion Project
SEVEN REF: 20923

DRAWING TITLE:
Phase 1 - Level Access External Works

DRAWING NO:
EPP | SEV | ZZ | 00 | DR | A | 01156 | P03

DATE: 11/01/25
REVISION: PRELIMINARY